

# THE ROCKINGHAM



**4 Bedrooms, 3 Bathrooms**

**Starting from £333,000**  
including plot

**Featuring:**

- Arched Portico
- Numerous Porches for Entertaining
- Large Master Suite
- Master Bath Features Dual sinks & Large Walk-In Closets
- Great Room
- Two Car Garage

**Total Living**  
**2,663 sq ft**

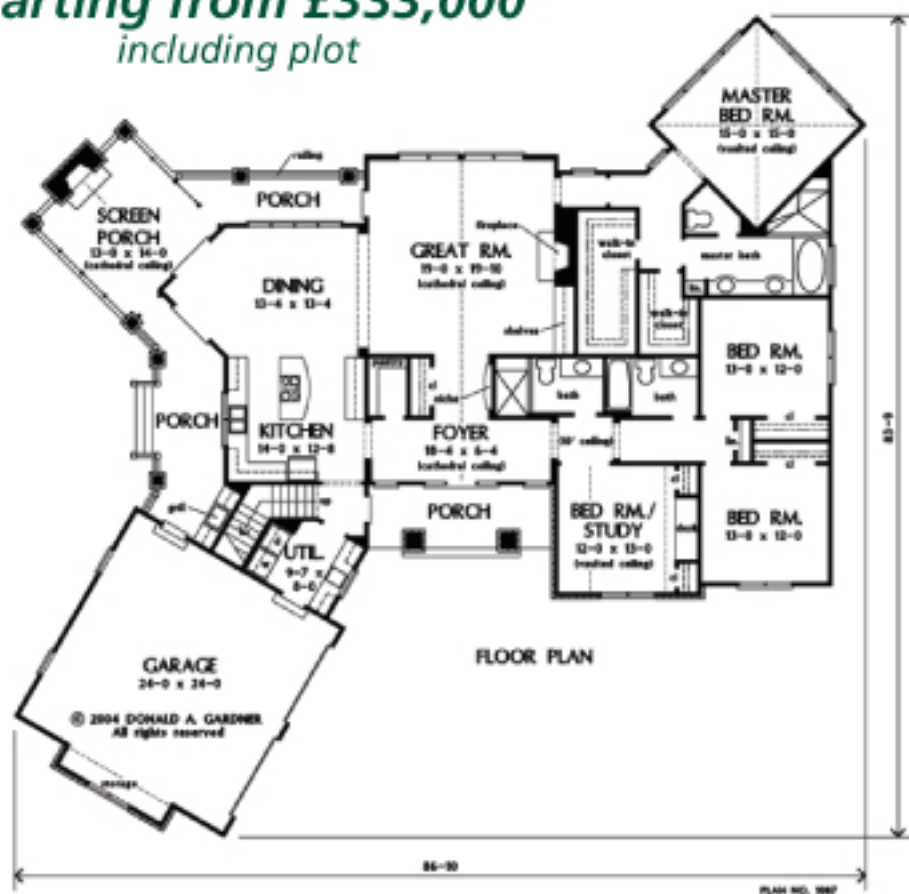

**undiscovered**  
International Property

The Malthouse, Shoelands Farm, Putterham Road, Seale, Surrey, GU10 1HL

Telephone: +44 (0)870 7347968 Email: [contact@undiscoveredproperties.com](mailto:contact@undiscoveredproperties.com) Web: [www.undiscoveredproperties.com](http://www.undiscoveredproperties.com)